



Nevada CBD Infrastructure Improvements

Public Information Meeting, Monday, December 11, 2019 6:00 PM



AGENDA

Nevada CBD Infrastructure Improvements Project Public Information Meeting December 11, 2019 6:00 PM

1. Welcome and Introductions
2. Project Background Information
 - a. Pavement and Underground Utilities Condition
 - b. Strategic priority
 - c. LHW/6th Street Traffic Signal Study
3. Project Scope
 - a. Geometrics (Paved Areas) including:
 - i. Typical Cross Sections
 - ii. Bumpouts
 - iii. ADA Accessibility
 - iv. Parking
 - b. Utilities – Storm Sewer, Sanitary Sewer and Water Main
 - c. Water and Sanitary Sewer Services
 - d. Streetlights and Electrical
 - e. Streetscaping
4. Schedule
 - a. Design – 7/2018 – 12/2019
 - b. Bid – Early 2020
 - c. Construct – 2020 and 2021
5. Other Items
 - a. Construction Phasing and Business Access
 - b. Snow Removal
6. Questions



Project Limits

North of M Avenue currently being removed from project (If good bids are received portions may be added back into the project)

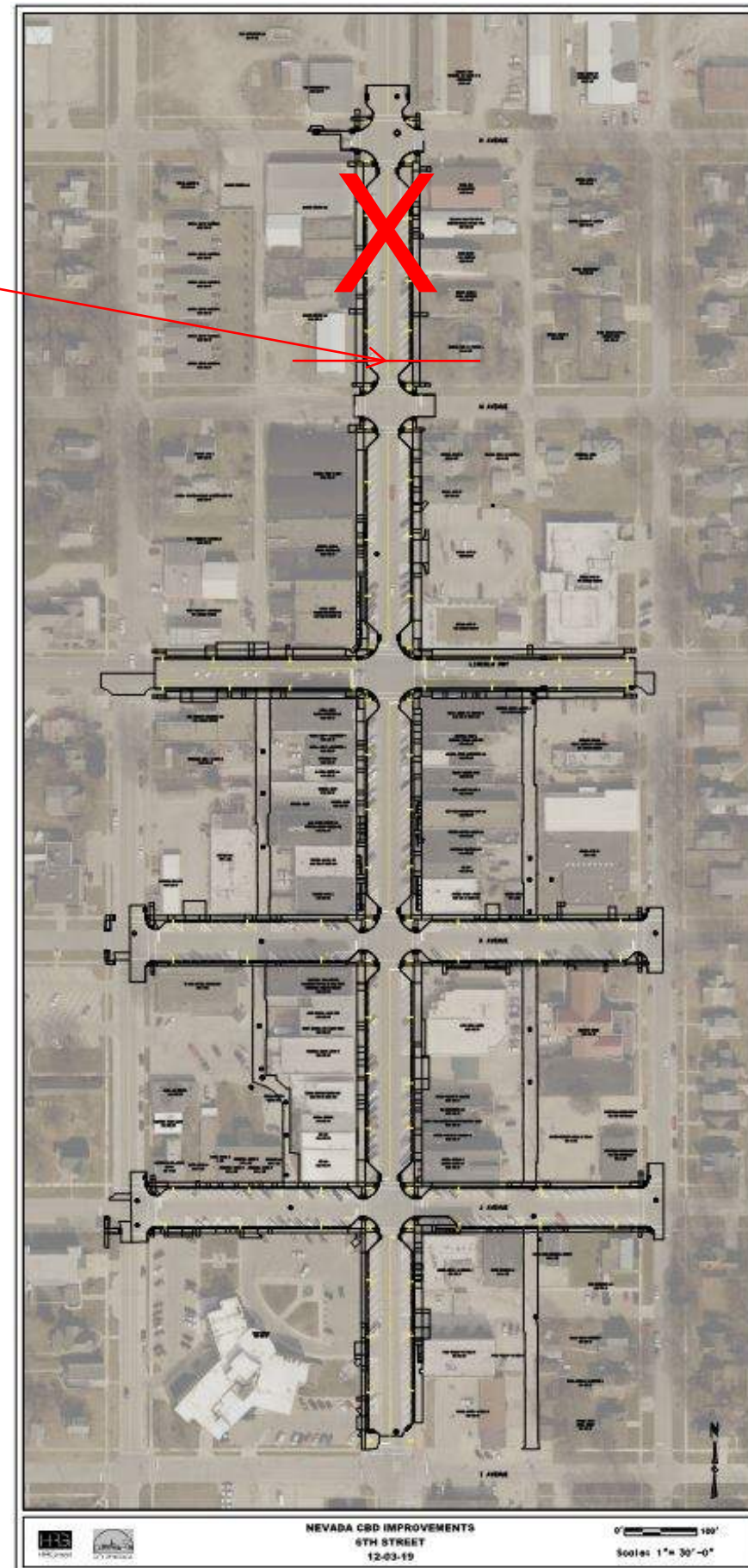

Project limits include the following:

- 6th Street from I Avenue to M Avenue
- J Avenue from 5th Street to 7th Street
- K Avenue from 5th Street to 7th Street
- Lincoln Highway from 5th Street to 7th Street
- All alleys between I Avenue and Lincoln Highway and between 5th Street and 7th Street

Current cost estimates for construction are higher than what was budgeted. Therefore, the last block at the north end initially slated to be a part of this project has been removed. It is still anticipated that water main will be installed in the last block from M-N Avenue, but all other improvements will stop at M Avenue.

Dependent on the bids received, portions of the project may be able to be added back into the project.

Geometrics

Parking Area:

Along 6th Street an additional 1' on each side of the street has been added to the parking area. The streetscaping band was reduced from 4' to 3' to accommodate this change. Sidestreets J Avenue and K Avenue will not change due to the narrower right of way available.

W Shape Cross Section:

The W shape cross section was used due to the varying existing elevations at the building faces that are needed to be matched. Existing sidewalks do not meet current ADA requirements, therefore the parking area will vary in slope to move the curb up and down to allow matching existing entrances while making the sidewalks ADA compliant.

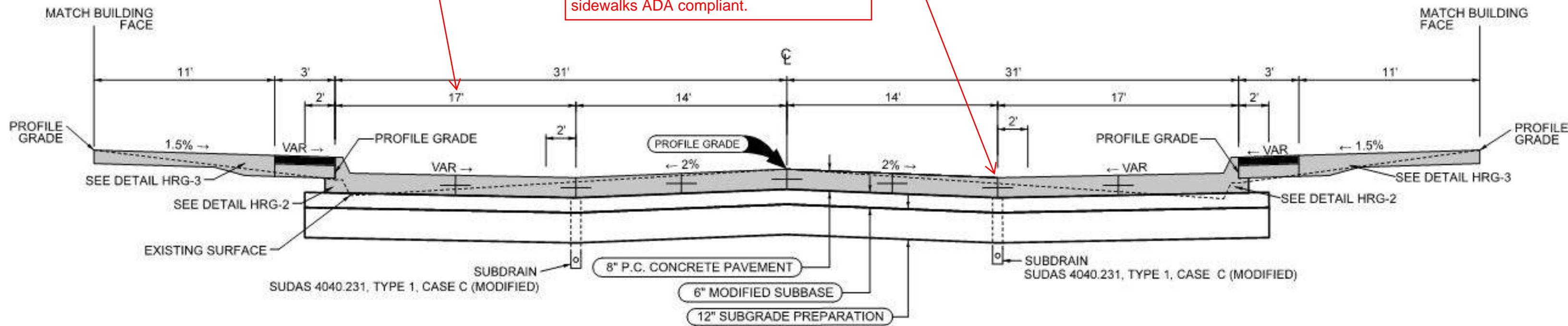

6th Street | Typical Cross Section

Bumpouts

Bumpouts will be provided at all intersections along 6th Street in the project area.

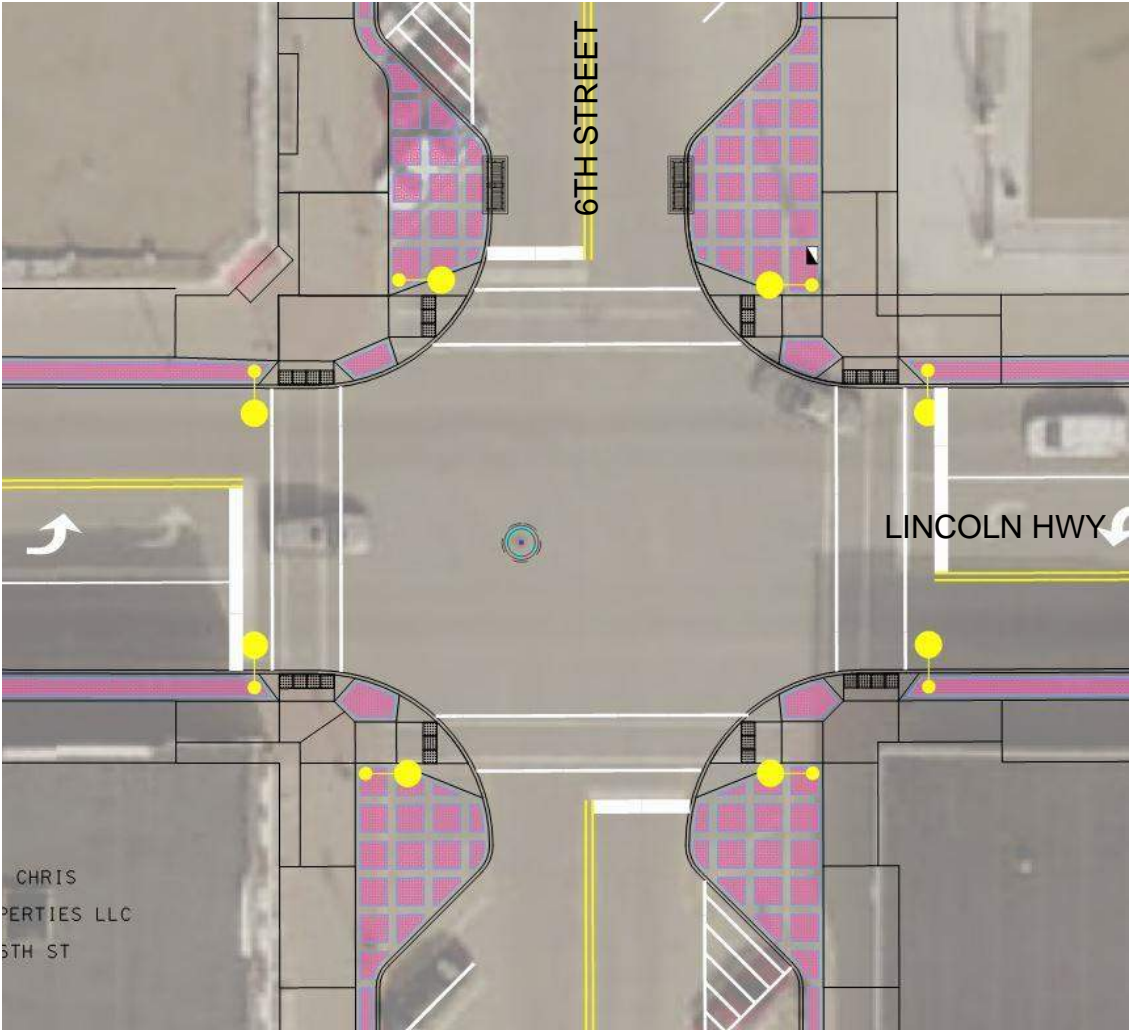
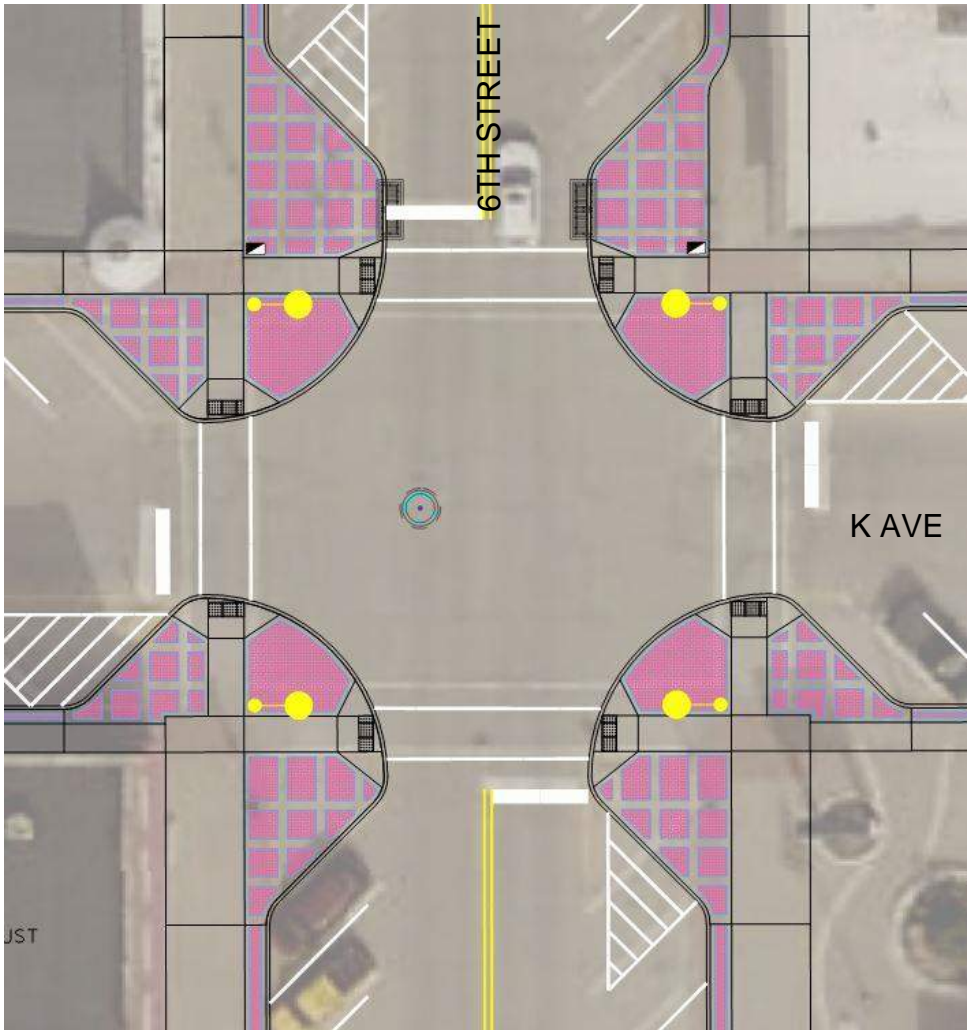

Existing Conditions

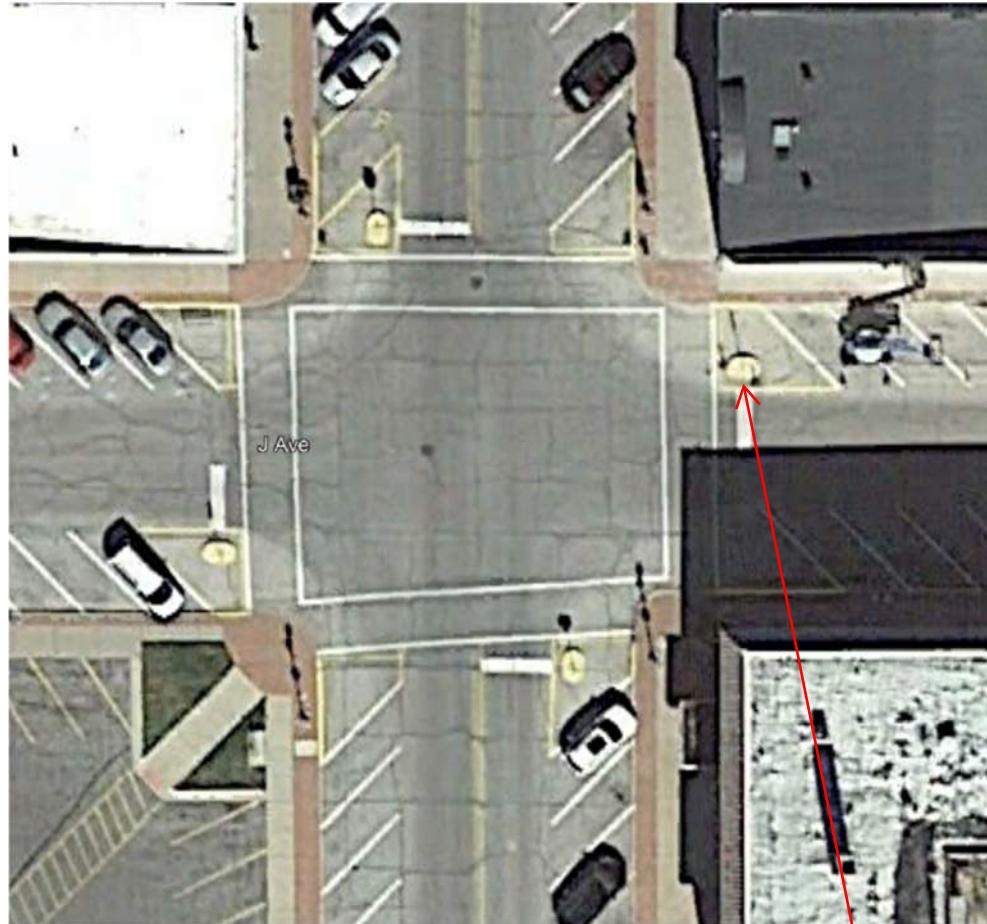

With stop sign islands and parking configuration, current conditions operate as bumpouts.

Underground Utilities/Services

City to provide water service, sanitary sewer service and 1-1/2" storm sewer sump line to each property.

City's contractor will cut hole in basement floor at coordinated location, with all 3 utilities brought in under the floor/foundation.

Property owners responsibility to then make the connection to their existing utilities.

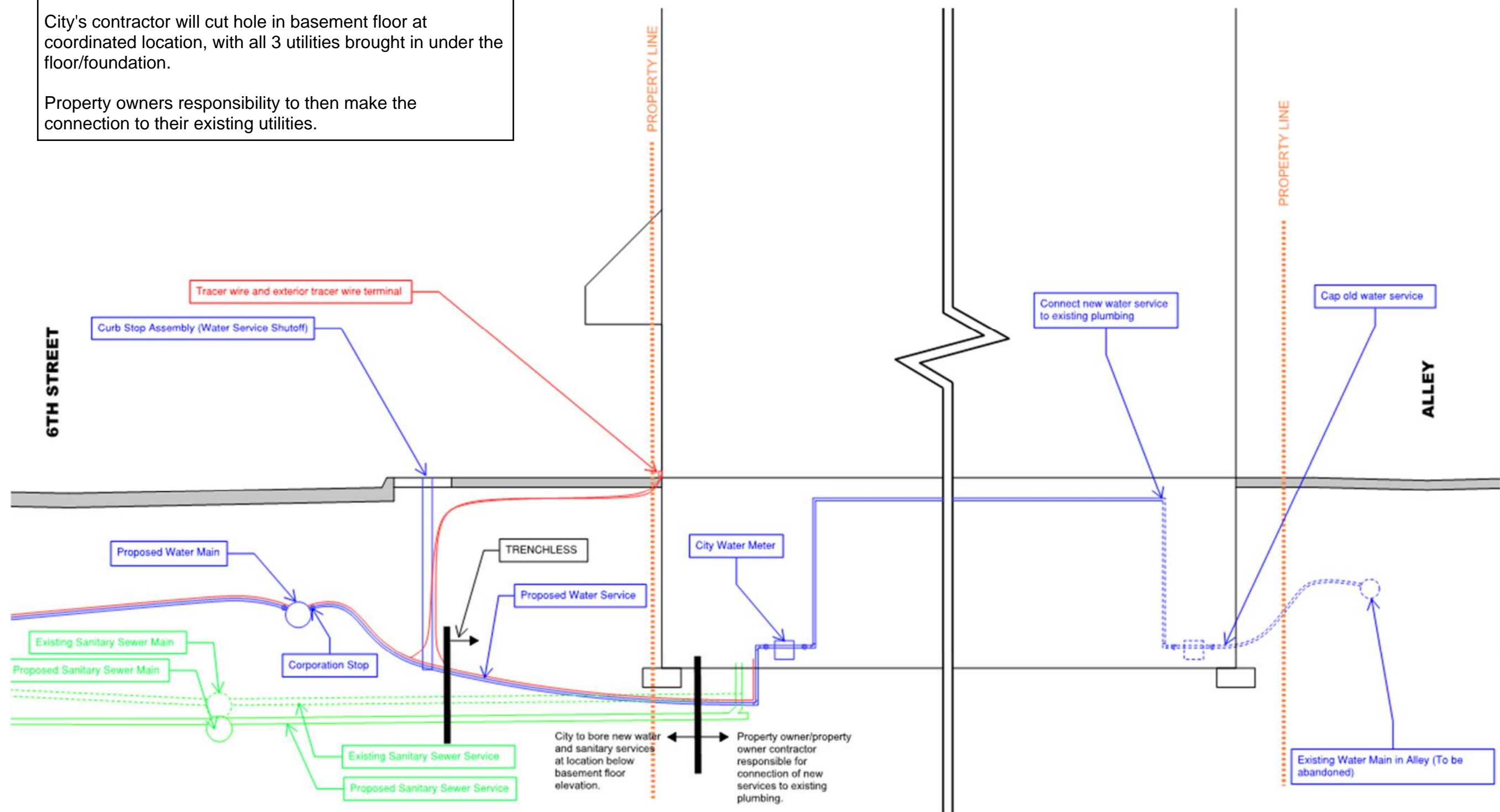

Existing Lighting



Proposed Lighting



Proposed Lighting Matches City Hall

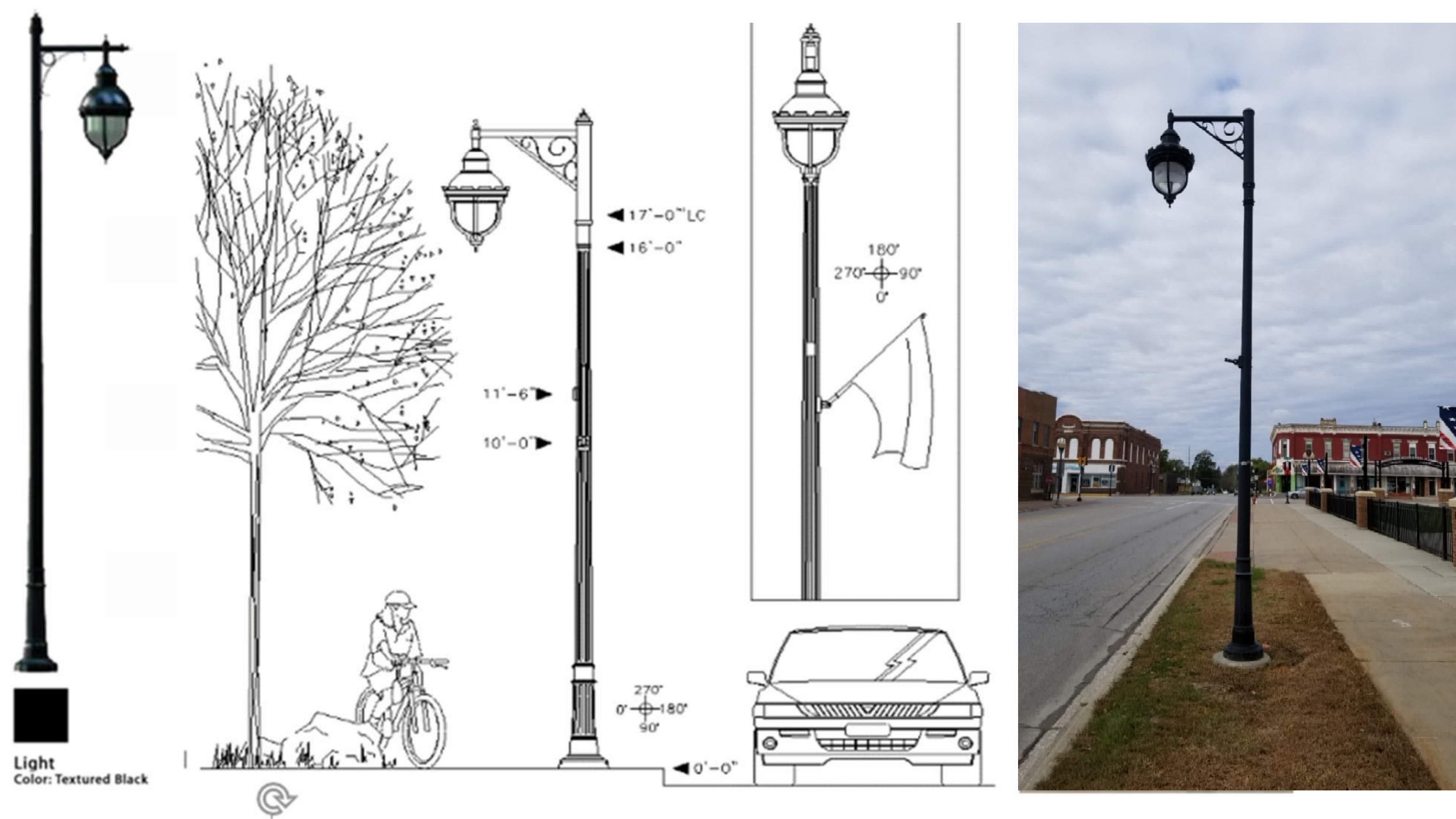

Power Outlet Pedestals To Be Provided For Downtown Events

8
MILLENNIUM
SERIES
POWER OUTLET
PEDESTALS

Power Outlet Pedestals

125 Amps | Unmetered | 120/240 VAC



U5200-XL-75

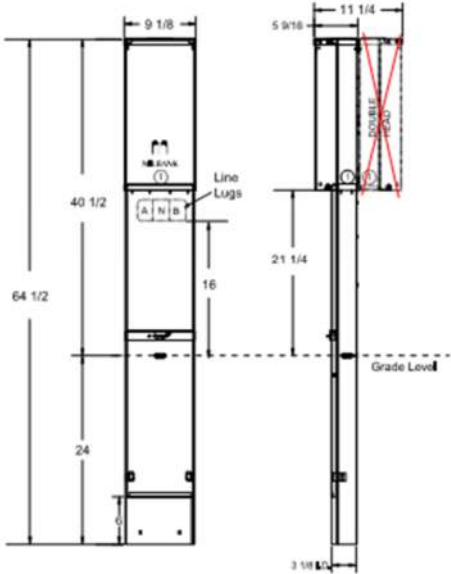

Specifications

- UL listed 125 Amps, 120/240 Volt—1Ø power outlet.
- Short circuit current withstand rating 10,000 RMS symmetrical amperes.
- Type 3R welded enclosure for durable outdoor use.
- Enclosure constructed with galvanized 16 gauge steel.
- Direct burial or pad mounted post constructed with 16 gauge galvanized steel. Two removable front covers for ease of installation. Accepts up to (3) 2 1/2" conduits.
- ANSI 61 grey polyester powder coat finish.
- Convenient concentric knock-out configurations.
- Hub opening with closure plate allows for meter retrofit.
- Wire terminations accept copper or aluminum conductors for loop feed wiring.
- Line: (2) #6-350 kcmil per phase, ground: (2) #14-2/0, neutral: (2) #6-350 kcmil
- Six circuit plated copper interior accepts standard plug-in type circuit breakers. Rated up to 125 Amps.
- Three position self-grounded receptacle bridge accepts most standard NEMA receptacles with mounting plates.
- Components factory wired with stranded copper wire.
- Lockable hinge cover and dead front are removable for installation and maintenance. Stay-open hinge cover has safety interlock on dead front. Deadfront must be removed before hinge cover can be removed.
- LED or fluorescent site light kits available. Factory or field installable. See accessories page.
- Unit weight - single: 48 lbs., double: 70 lbs.



Please consult serving utility for their requirements prior to ordering or installing, as specifications and approvals vary by utility, and may require local electrical inspector approval. All installations must be installed by a licensed electrician and must comply with all national and local codes, laws and regulations. Milbank reserves the right to make changes in specifications and features shown without notice or obligation.

Milbank Manufacturing | 4801 Deramus Ave., Kansas City, MO 64120 | 877.483.5314 | milbankworks.com

Power Outlet Pedestals

125 Amps | Unmetered | 120/240 VAC

9
MILLENNIUM
SERIES
POWER OUTLET
PEDESTALS

125 Amps | Unmetered Power Outlet Pedestals

Catalog Number	Mounting Type	Powerheads	Receptacle Configuration	Circuit Breaker Configuration	Loop Feed	Connectors (Line)	Dimensions			Knockouts
							D"	W"	H"	1
U5200-XL	Direct Burial	Single	—	—	Yes	#6-350	5½"	8¼"	64½"	1¼"
U5200-XL-332	Direct Burial	Single	A	W	Yes	#6-350	5½"	8¼"	64½"	1¼"
U5200-XL-41	Direct Burial	Single	B	X	Yes	#6-350	5½"	8¼"	64½"	1¼"
U5200-XL-55	Direct Burial	Single	C	Y	Yes	#6-350	5½"	8¼"	64½"	1¼"
U5200-XL-75	Direct Burial	Single	D	Z	Yes	#6-350	5½"	8¼"	64½"	1¼"
U5210-XL	Pad Mount	Single	—	—	Yes	#6-350	5½"	8¼"	40½"	1¼"
U5220-XL	Direct Burial	Double	—	—	Yes	#6-350	11½"	8¼"	64½"	1¼"
U5220-XL-41	Direct Burial	Double	B	X	Yes	#6-350	11½"	8¼"	64½"	1¼"
U5220-XL-75	Direct Burial	Double	D	Z	Yes	#6-350	11½"	8¼"	64½"	1¼"
U5230-XL	Pad Mount	Double	—	—	Yes	#6-350	11½"	8¼"	40½"	1¼"

Receptacle Configurations

A	B	C	D

Circuit Breaker Configurations

W	X	Y	Z

Notes

- 20 Amps GFI receptacles are weather resistant and tamper resistant.
- 20 Amps GFI required at each RV site by UL and NEC 551-71.
- LED or fluorescent site light kits available. Factory or field installable. See accessories page.
- Contact factory for additional configurations not shown here.

Please consult serving utility for their requirements prior to ordering or installing, as specifications and approvals vary by utility, and may require local electrical inspector approval. All installations must be installed by a licensed electrician and must comply with all national and local codes, laws and regulations. Milbank reserves the right to make changes in specifications and features shown without notice or obligation.

Milbank Manufacturing | 4801 Deramus Ave., Kansas City, MO 64120 | 877.483.5314 | milbankworks.com



Power Outlet Pedestals To Be Provided For Downtown Events



Example image of pedestal

To be painted black to match light poles.

Streetscaping

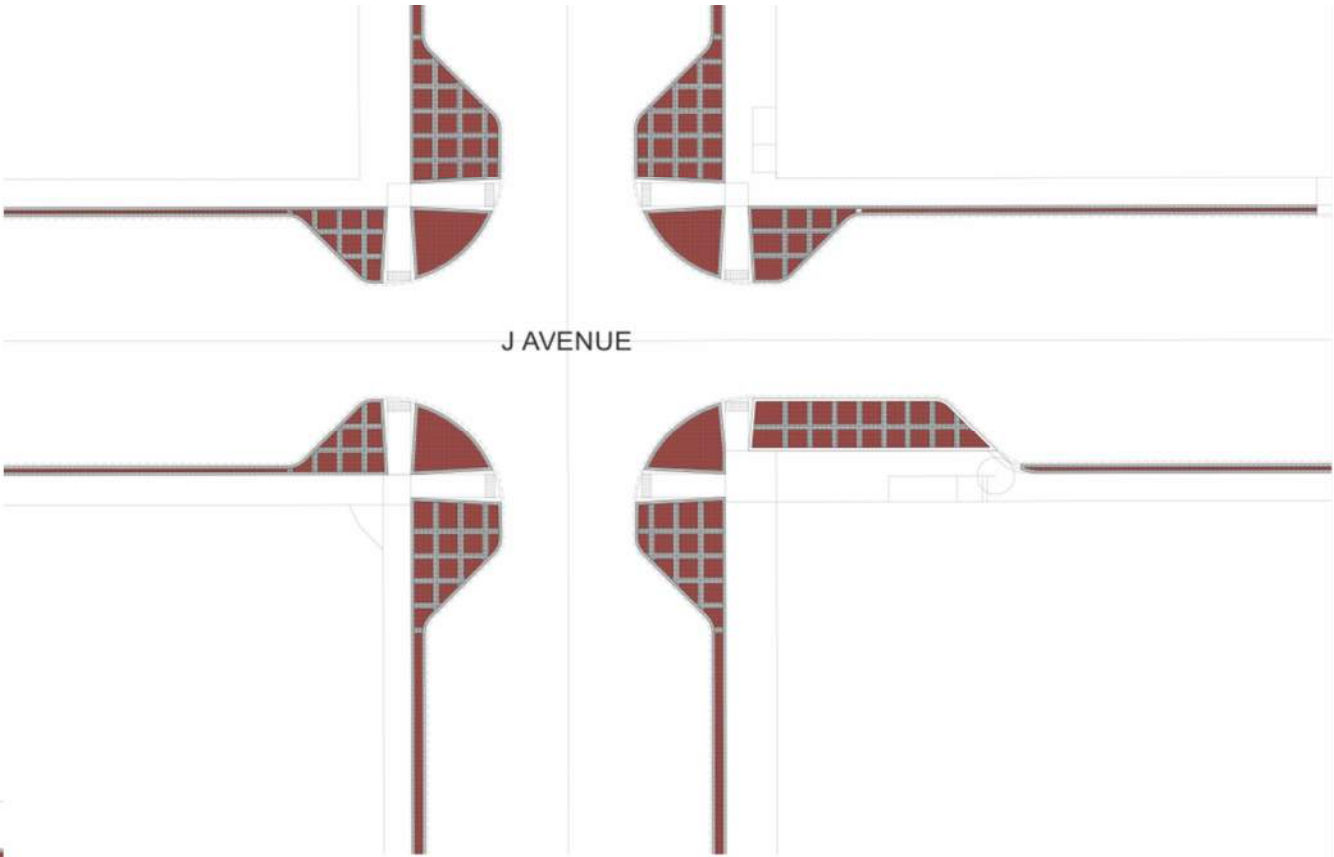
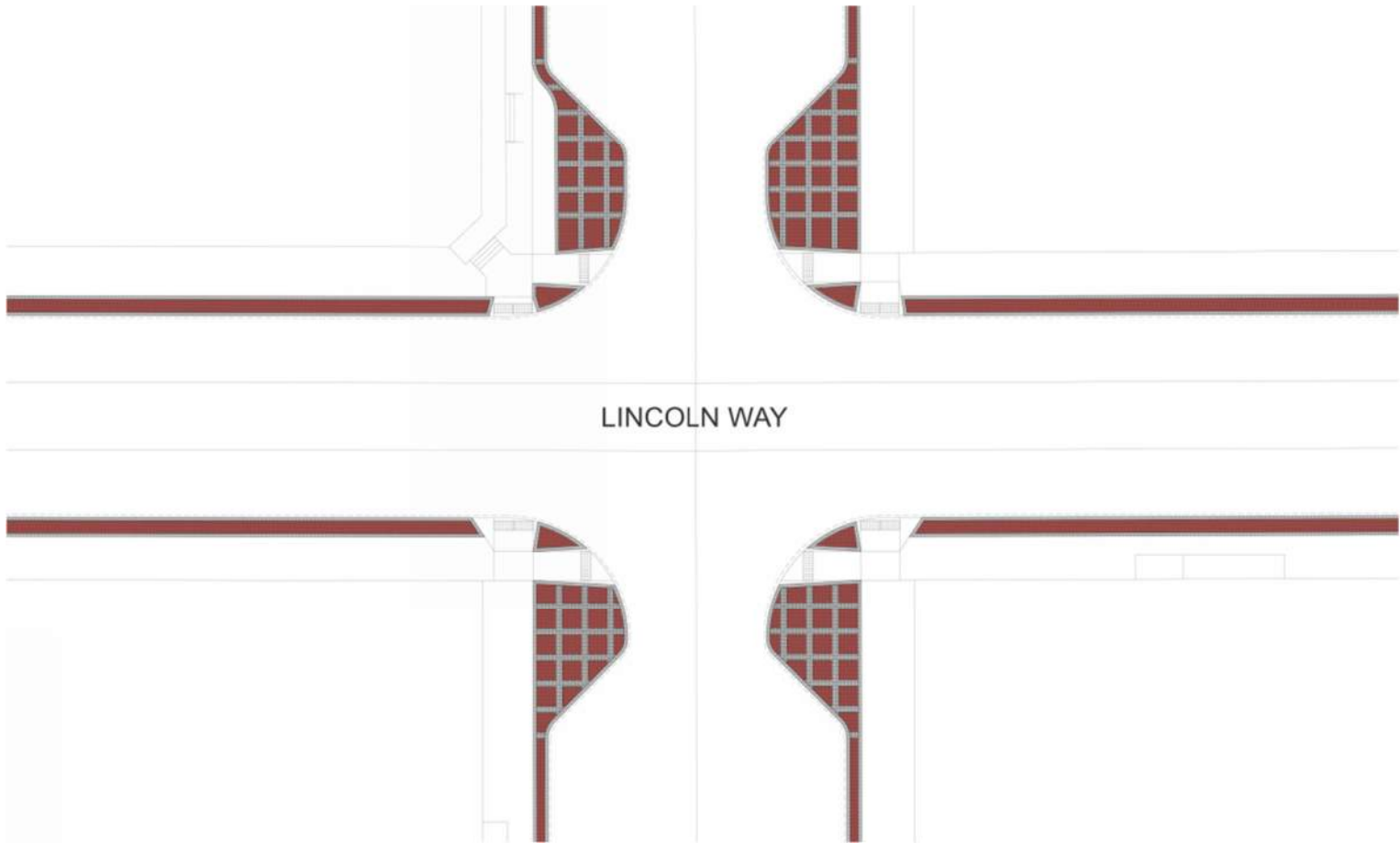

Streetscaping to include concrete pavers similar to current layout with slight modifications to color and pattern.



Streetscaping



Streetscaping to use concrete pavers similar to what currently exists in front of City Hall (Pattern to vary slightly from what is shown here).

Streetscaping

Improved detail to help prevent paver settlement. Polymeric sand to also be used to seal and lock pavers together.

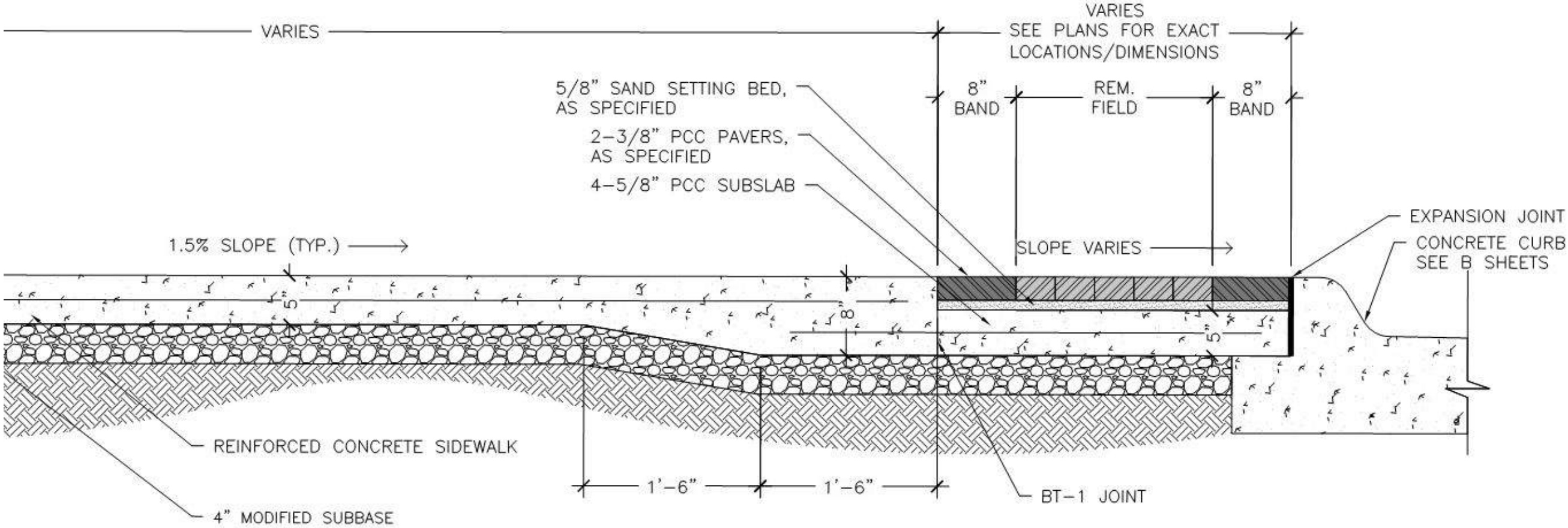

Construction Phasing

Construction to occur in 2 block increments, starting at the intersection of 6th Street/I Avenue and working north.

Anticipating completing Phases 1-3 in 2020 and Phases 4-7 in 2021.

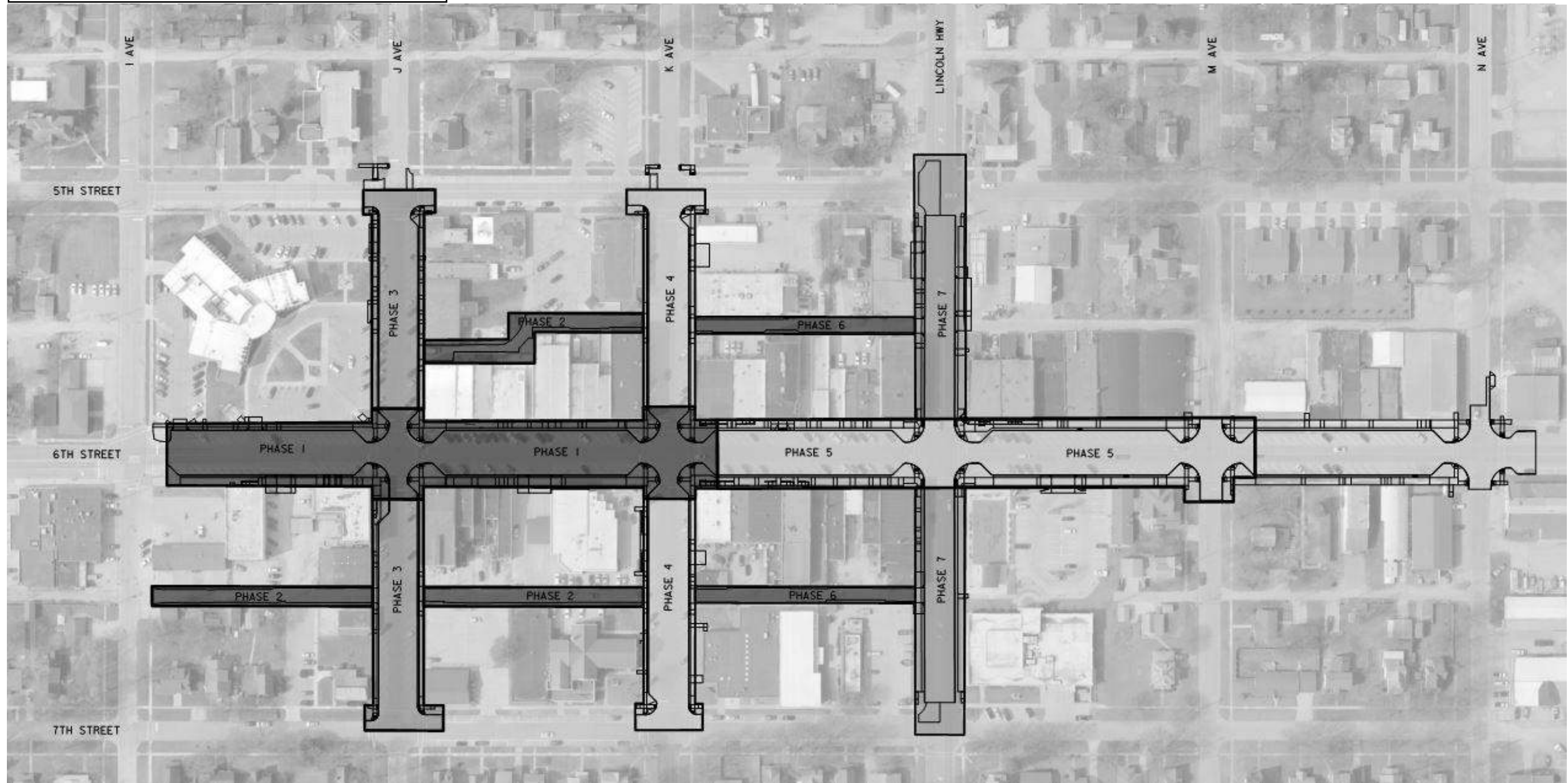

Construction Phasing

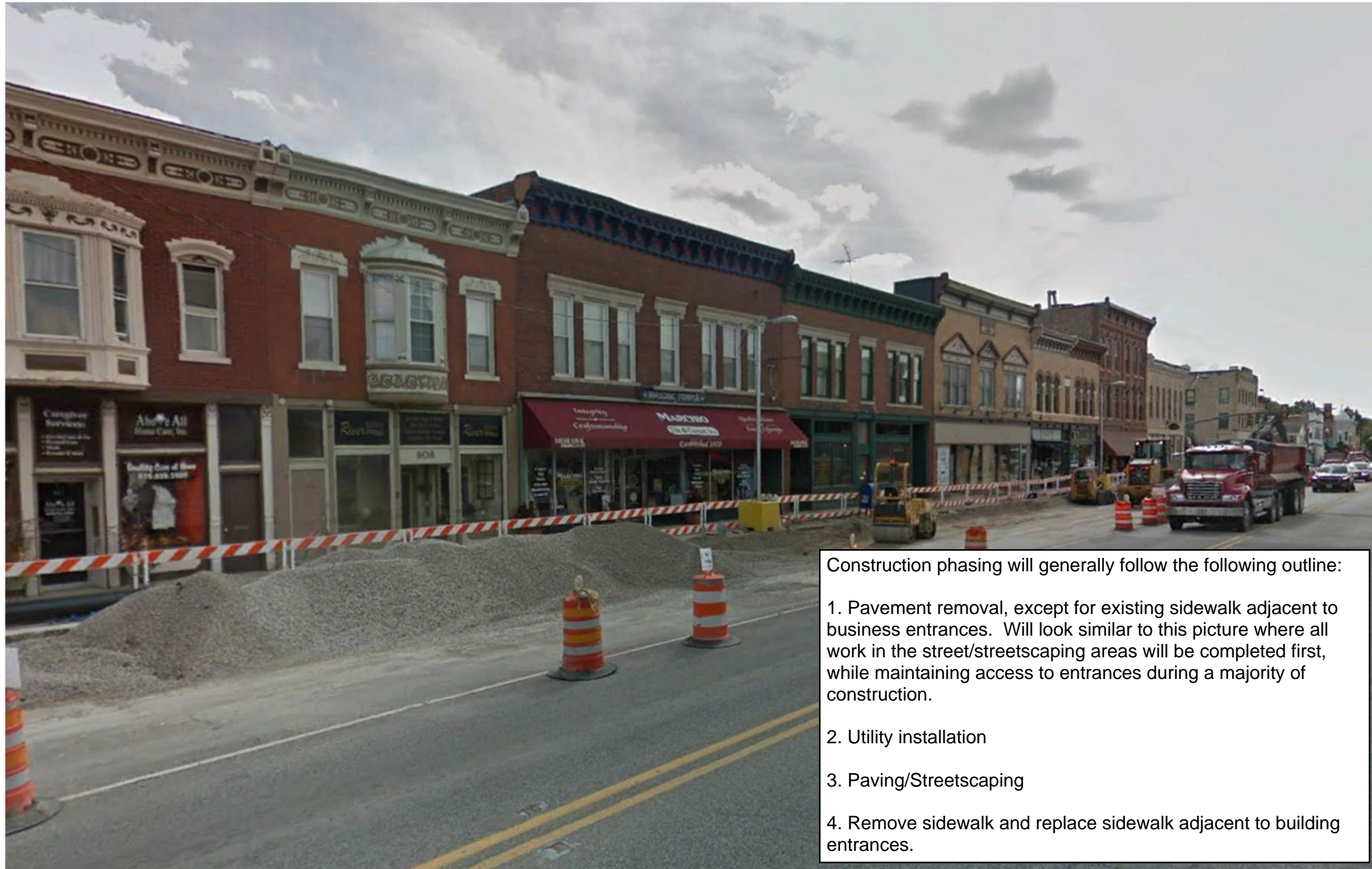



Contact Information



Larry J. Stevens, P.E., PWLF
Project Director

5525 Merle Hay Road, Suite 200 | Johnston | IA 50131
515.657.5273
lstevens@hrgreen.com

Brandon Mickelson, P.E.
Project Engineer

5525 Merle Hay Road, Suite 200 | Johnston | IA 50131
515.657.5310
bmickelson@hrgreen.com

Steven R. Junod, P.E.
Lead Engineer – Electrical

5525 Merle Hay Road, Suite 200 | Johnston | IA 50131
515.657.5284
sjunod@hrgreen.com